



ARTFORMA



# Operating and installation instructions Andes hall mirror





Thank you that you decided to buy our product. We made all our products taking care of each detail and we subject them to multiple tests. We are convinced that you made a purchase that will serve you for a long time.

## NECESSARY TOOLS

- A pencil
- A measuring tape or a ruler
- A level
- A wall plug included (8 mm)
- Mounting screws
- You will also need one person for help.
- A drill bit (8 mm)
- A drill and a screwdriver

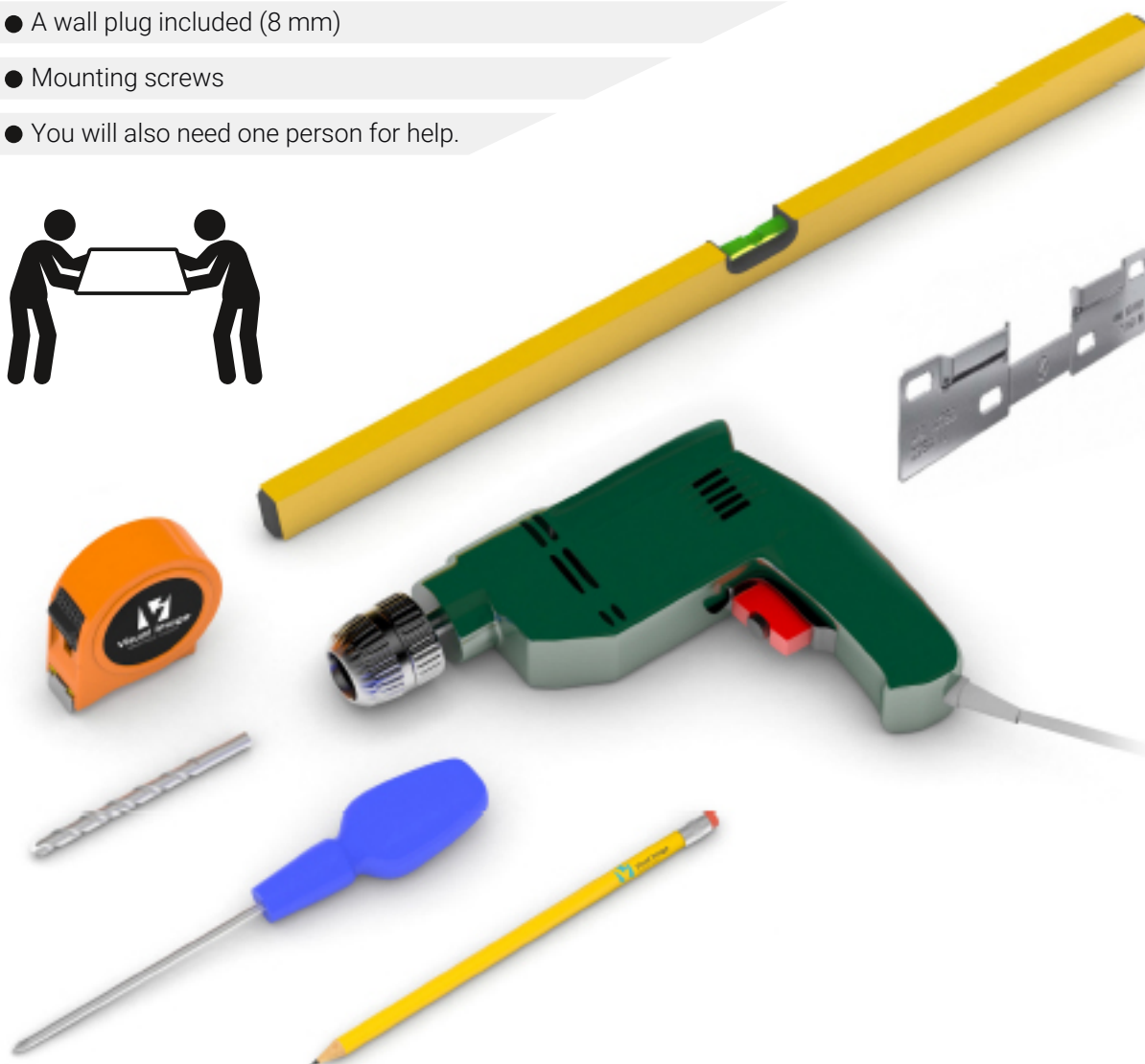
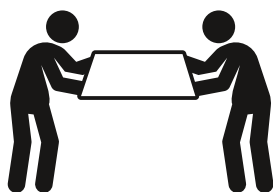

Read the instructions carefully before proceeding with the installation.  
Failure to follow the instructions may result in the refusal to accept the complaint.



# SECURITY



## Warning glass!

Place the mirror only on a soft surface. Frame corners are particularly susceptible to mechanical damage.



Good



Wrong



- Do not hang the mirror on movable elements of the interior equipment.
- Do not stick the mirror to the wall with mounting tape.
- Make sure the surface on which you want to hang the product will withstand the load on the mirror.  
The wall on which you hang the mirror should be at least 10 cm thick and made of durable material (e.g. concrete, brick, reinforced concrete, etc.)
- If you want to hang a mirror on a plasterboard wall (cardboard plaster), use the wall plugs intended for walls of this type (Molly pins). They are not included in the mounting kit.



# SAFETY



## Fire hazard!

Prolonged use of LED strip may cause it to become very hot. Do not place flammable objects near it. Mirrors with lighting can only be mounted on a flame-retardant or non-flammable surface.



## Burn hazard!

Avoid touching the lighting as it may become very hot.



## Fragile glass. Handle with care!

Take care when handling the corners of the mirror during installation, as they are particularly vulnerable to mechanical damage.



## Risk of breakage!

Depending on the size of the mirror, it may be heavy. We recommend having two people assist with the mounting process.

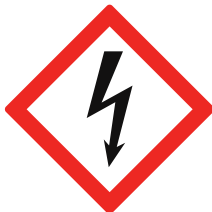

## High voltage!

Electrical installation should only be carried out by a qualified electrician.



## Product usage risk!

Keep products out of reach of very young children (0-3 years). Children between 3 and 8 years old should not have access to the product unless supervised at all times.

Children over 8 years old, elderly individuals, and those with reduced physical, sensory, or mental abilities may use the products only under supervision or if they have been trained on their safe use and understand the associated risks.



## Avoid Overloading!

Do not hang additional objects on the mirror. Adding extra weight could cause the mirror to fall.





# PREPARATION FOR MONTAGE

- 1.** First, open the package. Remember not to place the mirror on a hard surface as this may damage the product.
- 2.** Check if the package contains all the elements (product received according to the order, assembly elements).
- 3.** Then take the mirror out of the packaging and place it on a soft surface (you can use a folded towel for this).
- 4.** Make sure the product does not have any scratches or damage. Pay particular attention to the corners, check them first by removing the protections. If necessary, contact us, do not install the item with possible damage.

## Content:

- 1.** Mounting hook "L" 3 pcs.
- 2.** Assembly screws depending on the size:
  - 80 x 120 cm - 5 pcs.
  - 90 x 130 - 6 pcs.
  - 100 x 140 cm - 7pcs.





# Instruction for mounting on the wall

1. In order to determine the mounting location, start by marking the points on the wall, where the mounting screws will be placed (depending on the size of the mirror, this will be 5, 6 or 7 holes).

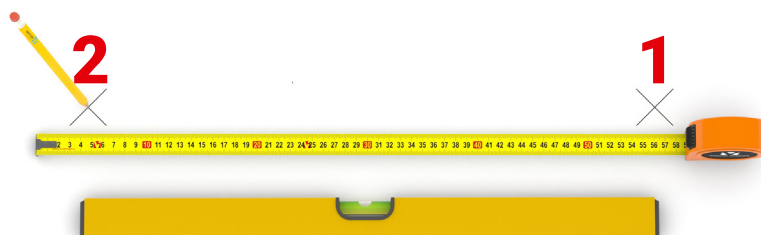



# Instruction for mounting on the wall

2. Using a level, check that the marked points are placed in an even line.

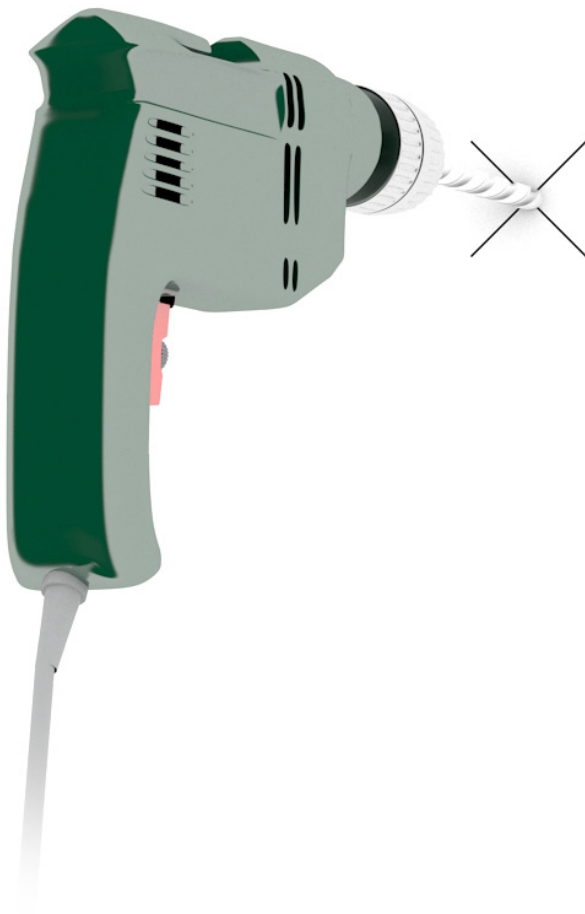

3. Check whether there is no installation in places that were determined to make holes there.
4. If there is any installation in the wall, choose another place for the mount.
5. Once you determine mounting places on the wall, drill holes there.
6. Put both wall plugs in the holes.







# Instruction for mounting one the wall

7. Hang the mirror on the back mounted mounting strip.



**Make sure that the power supply is disconnected - turn off the fuses!**

## **Attention!**

**To connect the product to the mains, use a Wago type connector.  
Remember to follow the rules for working with electrical installations or seek the help of an electrician.**

# **GUIDELINES RELATING TO CLEANING AND MAINTENANCE**

- If blurs remain on the glass after removing the protective film, use the included glue remover. You can eliminate any streaks with a glass cleaner.
- Use only agents intended for cleaning of glass surfaces and a dry microfibre cloth for everyday maintenance of the mirror.
- Avoid cleaning glass with silicone ore acidic agents. Cleaning agents of such kind may damage surface of the glass and induce its corrosion in the future.



# ARTFORMA

FORAM Sp. z o.o. sp. k.  
Karpicko ul. Jeziorna 3, 64-200 Wolsztyn

Mail EU: [hello@artforma.com](mailto:hello@artforma.com)

+48 68 422 73 65

**We are at your disposal from Monday to Friday from 9am to 3pm.**